

Discover™

Fast & Accurate

Drug Testing Made Simple

Saliva Drug Tests offer rapid and inexpensive screening test for the simultaneous detection of drugs in human saliva.

**NON
INVASIVE**

- No Urine handling
- Observed collection
- Simple 2-part device
- 99.9% accuracy
- Results in 5 minutes
- Low cost, easy, and fast
- No more collection fees
- Customizable



Fast & Accurate Drug Testing Solutions

AmericanScreening

Ron Kilgarlin
318.798.3306 ext. 111
sales@americanscreeningcorp.com

PH: 318.798.3306
FX: 318.798.3386
TF: 1.866.526.2873



Saliva Drug Tests

Detect the presence of drugs in minutes

Drug Name	Abbreviation	Cutoff Level
Amphetamine	AMP	50ng/ml
Methamphetamine	mAMP	50ng/ml
Cocaine	COC	20ng/ml
Opiates	OPI	40ng/ml
Marijuana	THC	12ng/ml
Phencyclidine	PCP	10ng/ml
Benzodiazepines	BZO	50ng/ml
Oxycodone	OXY	50ng/ml
Methadone	MTD	35ng/ml
Barbiturates	BAR	50ng/ml
Buprenorphine	BUP	10ng/ml
Alcohol	ALC	>0.02% BAC
Ethyl Glucuronide	ETG	500ng/ml

COLLECTION PROCEDURE

1. Remove the saliva collector from sealed pouch and swab the inside of the mouth for 3 minutes to soak sponge.
2. Place the saliva collector into the tube and press down. For saliva cassette place saliva collector into the tube and screw on the cap. Unscrew the bottom cap and squeeze 2 to 3 drops of fluid into each sample well.
3. Read results of drug tests at 5 to 10 minutes, read alcohol test result at 2 to 5 minutes. Do not read drug test results after 1 hour, do not read the alcohol test result after 5 minutes.

DISCOVER ONESTEP TEST



DISCOVER SALIVA CASSETTE

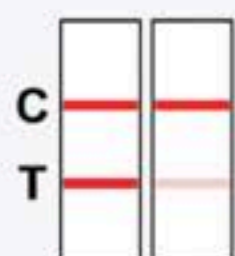
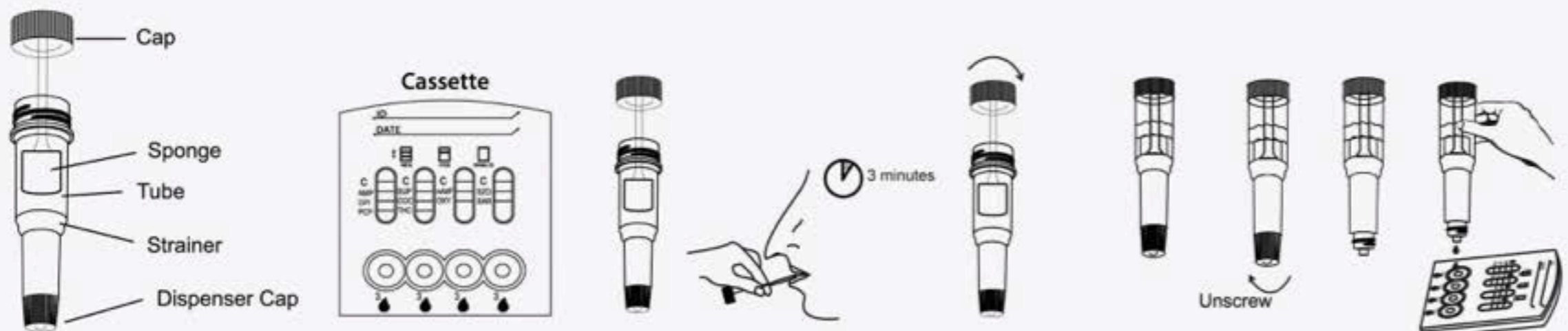

Negative

(2 Lines-Any indication of a line in both test and control fields is to be interpreted as a NEGATIVE)

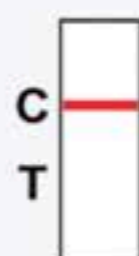

Positive

(1 Lines)



Invalid

(No line(s) or no control line(s))